

# STRATFORD HALL PLANTATION

## A Survey of the Architectural Landscape

Kaley Huston

### Stratford Plantation Landscape

Stratford Hall Plantation is an 18th-century plantation located in the Northern Neck of Virginia. Many changes have altered its architectural landscape through the years, most notably in a restoration of landscape, outbuildings, and plantation house stairs taking place circa 1930, by Fiske Kimball. The reconstructions made the entrances more dramatic and emphasized the importance of the main house.



Stratford Hall Plantation, Main House

### Research Objectives

- How do the outbuildings of Stratford Hall Plantation spatially and physically relate to the main house?
- How have reconstructions changed the landscape of Stratford Hall Plantation?
- How can we visualize and appropriately represent these changes using computer applications and technology?

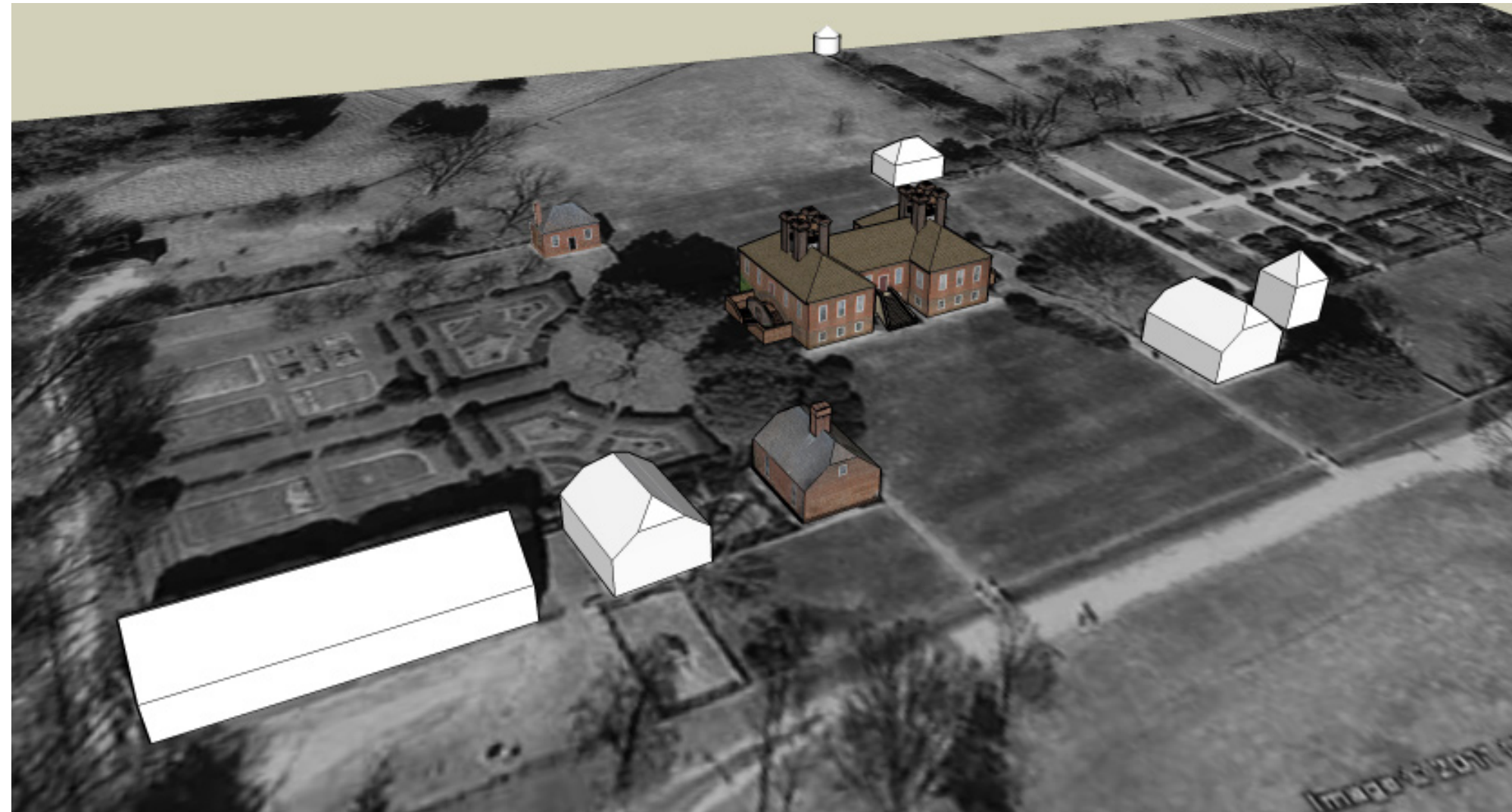

Stratford Hall Plantation Google SketchUp and Google Earth

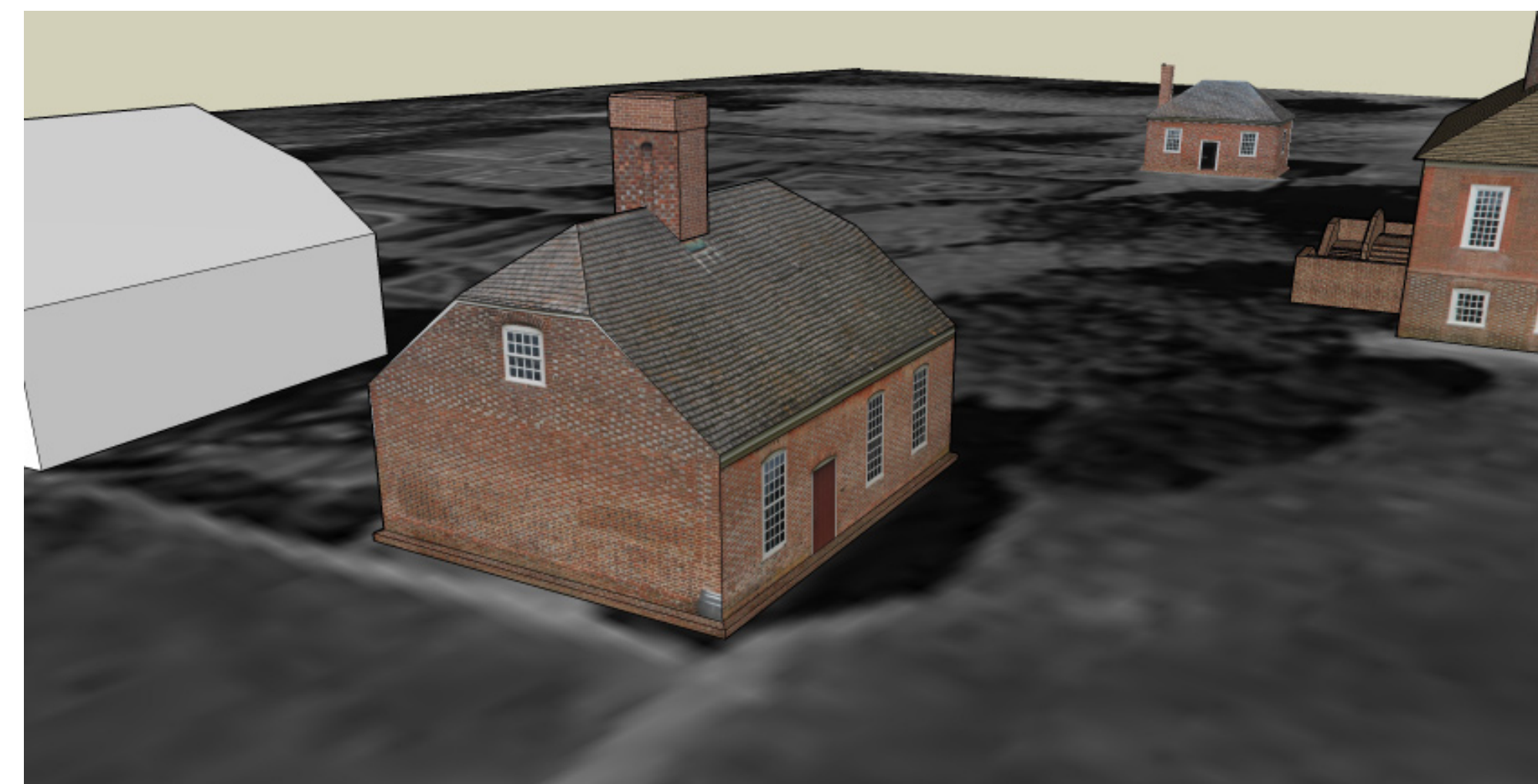

TachyCAD buildings are represented in brick, while other buildings are white

### Research Process

We used the existing HABS drawings to render the main plantation house in Google Sketchup. We took TachyCAD and Total Station points of two outbuildings, rectified photographs of the two outbuildings within PhotoPlan, and utilized AutoCAD to gather the dimensions of the structures. We uploaded the resulting Google Sketchup models into Google Earth to more accurately present the landscape.

### Original Structures

The original structures are closest to the main house. The structures include an overseer's office, garden storage, servants quarters and the kitchen. They are made of brick with two plans. They are largely unaltered, on the exterior, from the time of their construction. However, interior renovations have been necessary due to their age.



Original outbuilding, connected to landscaping wall



Reconstructed outbuilding

### Reconstructed Structures

These structures used to serve a more specific function on the plantation, such as the stables, smokehouse and slaves quarters. These structures were used by slaves and servants, so they were the most likely to fall into disrepair when fewer people inhabited the plantation. The reconstructed structures are generally further away from the main house.